

Timer type 726 006 022



60 minute, 2 horizontal contacts,
mounted with two screws $\varnothing 3,2$

Applications:

* Battery chargers, ultrasonic cleaners, saunas, tanning beds, medical equipment, dryers, small appliances, and food service equipment.

Standard Features

- * max 16 A (active power) and 3 A (for reactive (inductive) power) 240V
- * max 10 A (active power) 2 A (for reactive (inductive) power) – 400 V
- * 1/4 HP 120/250 Vac 60Hz
- * 15A 1000 WT

Certificates:

* VDE, ENEC, CSA, UL

MOUNTING FOR TIMER

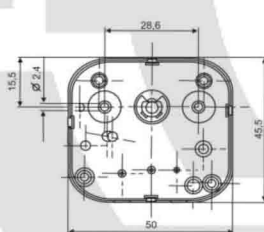

TYPE OF COVER

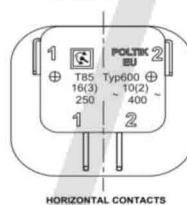

HORIZONTAL CONTACTS

TURNING ANGLE

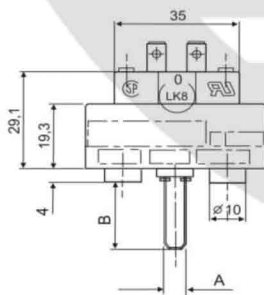
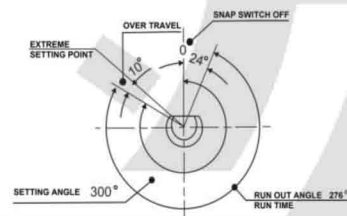

TYPE OF SWITCH

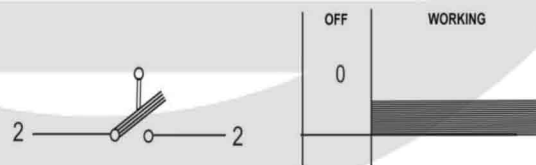

SHAPE OF SHAFT

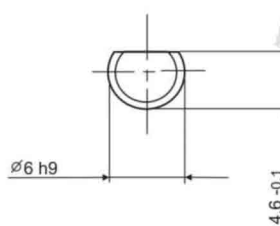

POSITION "0"

